

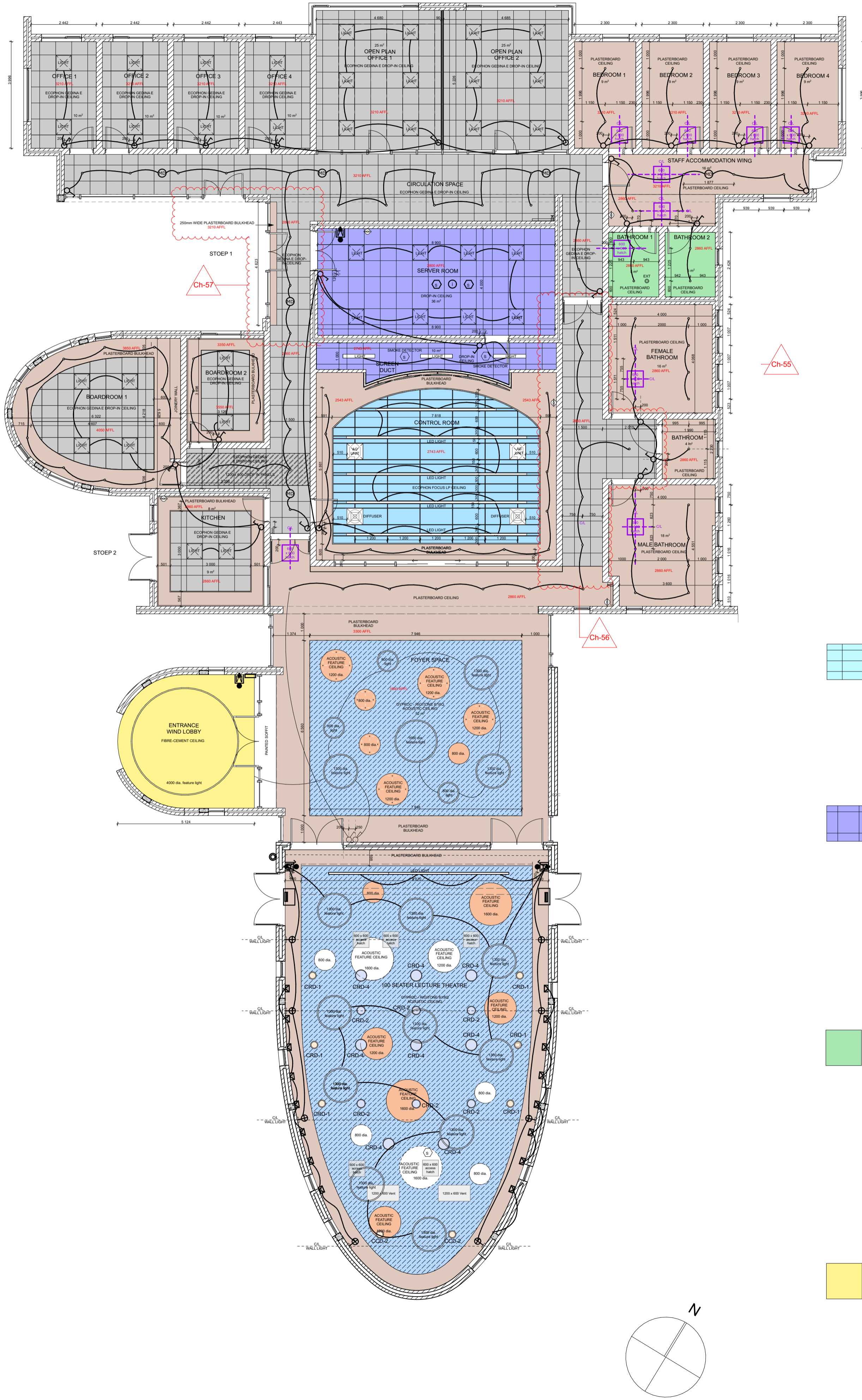

SPACE WEATHER CENTER - CEILING PLAN
scale 1 : 100 @ A1

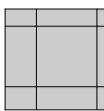
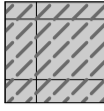

PLEASE NOTE: contractor to provide samples on site for final approval

CEILING FINISHES	
	DROP IN CEILING TILES : 600 x 600 x 15 mm Ecophon Gedina E density glass wool ceiling tiles. The ceiling should consist of suspended glass fiber ceiling panels Ecophon Gedina (edge E) with tegular (reveal) edge design, creating a ceiling with a shadow effect that accentuates each tile and partially conceals the grid system. System: Install GyframeTM/DONN T38FR Main Tee (0.4mm thickness, Z150 galv coating, locally manufactured, recycled content, ISO 9001 & 14001 certification) at 1200mm c/c suspended using Gyproc Hanger Strap 19mm to the Main Tee web using 2 steel pop-nuts or one Gyproc Wafer-Head Tek screw. Install GyframeTM/DONN T38FR Cross Tee (1200mm long) at 600mm c/c to create a 1200mm x 600mm ceiling grid. Install GyframeTM/DONN T38FR Cross Tee 600mm into the 1200mm long cross tee to create a 600mm x 600mm ceiling grid. Install hold down clips, in areas susceptible to draught. Perimeter - Fix Gyproc/DONN SM 25 Wall Angle (locally manufactured) to the wall using fixings at 300mm centres. Install angle cleats fixed to the wall to ensure straight grid and stability.
	DROP IN CEILING TILES : 1200 x 600 x 15 mm Ecophon Gedina E density glass wool ceiling tiles. The ceiling should consist of suspended glass fiber ceiling panels Ecophon Gedina (edge E) with tegular (reveal) edge design, creating a ceiling with a shadow effect that accentuates each tile and partially conceals the grid system. System: Install GyframeTM/DONN T38FR Main Tee (0.4mm thickness, Z150 galv coating, locally manufactured, recycled content, ISO 9001 & 14001 certification) at 1200mm c/c suspended using Gyproc Hanger Strap 19mm to the Main Tee web using 2 steel pop-nuts or one Gyproc Wafer-Head Tek screw. Install GyframeTM/DONN T38FR Cross Tee (1200mm long) at 600mm c/c to create a 1200mm x 600mm ceiling grid. Install GyframeTM/DONN T38FR Cross Tee 600mm into the 1200mm long cross tee to create a 600mm x 600mm ceiling grid. Install hold down clips, in areas susceptible to draught. Perimeter - Fix Gyproc/DONN SM 25 Wall Angle (locally manufactured) to the wall using fixings at 300mm centres. Install angle cleats fixed to the wall to ensure straight grid and stability.
	PLASTERBOARD CEILING : Flush plastered Ceilings 1x RhinoBoard® 9mm (locally manufactured, ISO 9001 & 14001 certification, recycled paper content, Greentag Level B) fixed to Gyframe®/DONN T32K Cross Tee (0.4mm thickness, Z150 galv coating, locally manufactured, recycled content, ISO 9001 & 14001 certification) using Gyproc Sharp-point Screws 25mm at maximum 150mm centres. Gyframe®/DONN T37K Main Tee installed at 1200mm centres and suspended using Gyproc Galvanised Angle 25mm x 25mm hangers at 1200mm centres. Gyframe®/DONN T32K Cross Tee at 400mm centres. Hanger to be maximum 400mm from perimeter wall. Apply Gyproc RhinoTape® to all joints. Cover Gyproc RhinoTape® with 1 layer of Gyproc RhinoLite® Multipurpose/ RhinoLite® Natural Plus® (phosphogypsum, locally manufactured). Install Gyframe® Corner Bead to all external corners. Gyproc/ DONN Plaster Trim 9.5mm (locally manufactured) to the wall using fixings at 300mm centres. 135mm thick flexible, non-combustible, lightweight Aerolite insulation material between the roof trusses and over branding/purins in a completed roof and ceiling system. Install in accordance with the manufacturers detail and specification. • Ceiling System: Gyproc Skimmed Ceiling System 9.5mm/SB • Ceiling Grid: concealed ceiling grid.

Bulkheads

Skimmed plasterboard bulkhead(s) to Architects's details - 1x RhinoBoard® 9mm (locally manufactured, ISO 9001 & 14001 certification, recycled paper content, Greentag Level B) fixed to Gyframe®/DONN T32K Cross Tee (0.4mm thickness, Z150 galv coating, locally manufactured, recycled content, ISO 9001 & 14001 certification) using Gyproc Sharp-point Screws 25mm at maximum 150mm centres. Gyframe®/DONN T37K Main Tee installed at 1200mm centres and suspended using Gyproc Galvanised Angle 25mm x 25mm hangers at 1200mm centres. Gyframe®/DONN T32K Cross Tee at 400mm centres. Hanger to be maximum 400mm from perimeter wall. Apply Gyproc RhinoTape® to all joints. Cover Gyproc RhinoTape® with 1 layer of Gyproc RhinoLite® Multipurpose/ RhinoLite® Natural Plus® (phosphogypsum, locally manufactured). Install Gyframe® Corner Bead to all external corners. Gyproc/ DONN Plaster Trim 9.5mm (locally manufactured) to the wall using fixings at 300mm centres. 135mm thick flexible, non-combustible, lightweight Aerolite insulation material between the roof trusses and over branding/purins in a completed roof and ceiling system. Install in accordance with the manufacturers detail and specification.
• Ceiling System: Gyproc Skimmed Ceiling System 9.5mm/SB
• Ceiling Grid: concealed ceiling grid

ACOUSTIC CEILINGS :

Gyproc Rigitone Acoustic Ceiling

Rigitone® 818 Q 12.5mm (ISO 9001 & 14001 certification) fixed to Gyframe®/DONN T32K Cross Tee (0.4mm thickness, Z150 galv coating, locally manufactured, recycled content, ISO 9001 & 14001 certification) using Gyproc Sharp-point Screws 25mm at maximum 150mm centres. Gyframe®/DONN T37K Main Tee installed at 1200mm centres and suspended using Gyproc Galvanised Angle 25mm x 25mm hangers at 1200mm centres. Gyframe®/DONN T32K Cross Tee at 300mm centres. Hanger to be maximum 400mm from perimeter wall. Finish the joints and spot the screw heads using Rigitone® Vario Joint Filler. Install Gyframe® Corner Bead to all external corners. Gyproc/DONN SM25 Wall Angle (locally manufactured) to the wall using fixings at 300mm centres. 50mm thick non-combustible, lightweight Energylite Glasswool insulation blanket/batts of 47.5 kg/m3 density for improved acoustic performance. Install in accordance with the manufacturers detail and specification.
• Ceiling System: Gyproc Acoustic Ceiling System (Boards) Rigitone® 8-18 Q
• Ceiling Grid: concealed ceiling grid.

ACOUSTIC FEATURE CEILING PANELS :

Glass fibre acoustic free-hanging units Ecophon Solo Circle 1600 dia. / 1200 dia. / 800 dia. x 40mm. Colour : White Frost, hanging position TBC on site, with a weight of approximately 6.5 – 14.5 kg. Panels installed using of the following systems: Connect Adjustable wire hangers, Connect One-point fixing or ConnectAbsorber brackets-all in combination with the Connect Absorber anchor (patented) to give the possibility to create several layers and angles. The system should be installed according to Ecophon installation diagrams M404, M405, M406, M407 and M408.

ACOUSTIC FEATURE CEILING PANELS :

Glass fibre acoustic free-hanging units Ecophon Solo Circle 1600 dia. / 1200 dia. / 800 dia. x 40mm. Colour : Sunset Heat, hanging position TBC on site, with a weight of approximately 6.5 – 14.5 kg. Panels installed using of the following systems: Connect Adjustable wire hangers, Connect One-point fixing or ConnectAbsorber brackets-all in combination with the Connect Absorber anchor (patented) to give the possibility to create several layers and angles. The system should be installed according to Ecophon installation diagrams M404, M405, M406, M407 and M408.

- NOTE**
- THE DESIGN ON THIS DRAWING IS COPYRIGHT AND REMAINS THE PROPERTY OF THE ARCHITECT.
 - ALL WORK IS TO BE CARRIED OUT IN ACCORDANCE WITH THE N.B.R. SANS 10400 AND LOCAL AUTHORITY REGULATIONS.
 - THE DRAWING IS NOT TO BE SCALED.
 - ANY DISCREPANCIES ARE TO BE IMMEDIATELY REPORTED TO THE ARCHITECT.
 - ALL DIMENSIONS AND LEVELS ARE TO BE CHECKED ON SITE PRIOR TO CONSTRUCTION.

RevID	Issue Date	Change ID	Change Name
04	2021/10/13	Ch-57	Ceiling in passage revised
		Ch-58	Ceiling type changed from Flush plasterboard ceiling to the Ecophon Gedina E ceiling
		Ch-55	Ceiling hatch locations revised
		Ch-42	Diffuser positions revised and access hatches added to Ceiling layout
03	2021/10/07	Ch-41	Ceiling hatch position revised
02	2021/09/29	Ch-37	Ceiling access hatches added to Ceiling layout
01	2021/07/12	Ch-38	Boardroom Ceiling heights revised
		Ch-11	Ceiling Specifications revised
		Ch-04	Ceiling Heights in Control Room and Screen Duct Revised

OWNER	
SOUTH AFRICAN NATIONAL SPACE AGENCY	
Date	
ARCHITECT	
Date	
ENGINEER	
Date	

PROJECT
SOUTH AFRICAN NATIONAL SPACE AGENCY

FOR SOUTH AFRICAN NATIONAL SPACE AGENCY
ON ERF : 9875

ARCHITECT

AVNA Architects and Green Building Consultants (PTY) Ltd.

avna architects

ARCHITECT

SCHOONRAAD ARCHITECTS

CLIENT

sansa SPACE AGENCY

DRAWING TITLE
SPACE WEATHER CENTER - CEILING PLAN

BUILDING CLASSIFICATION
A1 / G1 / H3

CLIMATIC ZONE
ZONE 4

RESPONSIBLE PERSON
HEDI MCALLISTER

DATE
2021/10/13

DRAWN
JUSTINE ALEXANDER

FOR Erection

DRAWING PATH
B:\Meivut OLACTBM01 - BIMcloud Basic for ARCHICAD 23\ CT1413 Space Weather Center - Construction Drawings - Current

SCALE
1 : 100

SHEET SIZE
A1

PROJECT No.
CT1413

DRAWING NUMBER
SWC - 1300

REVISION
04